

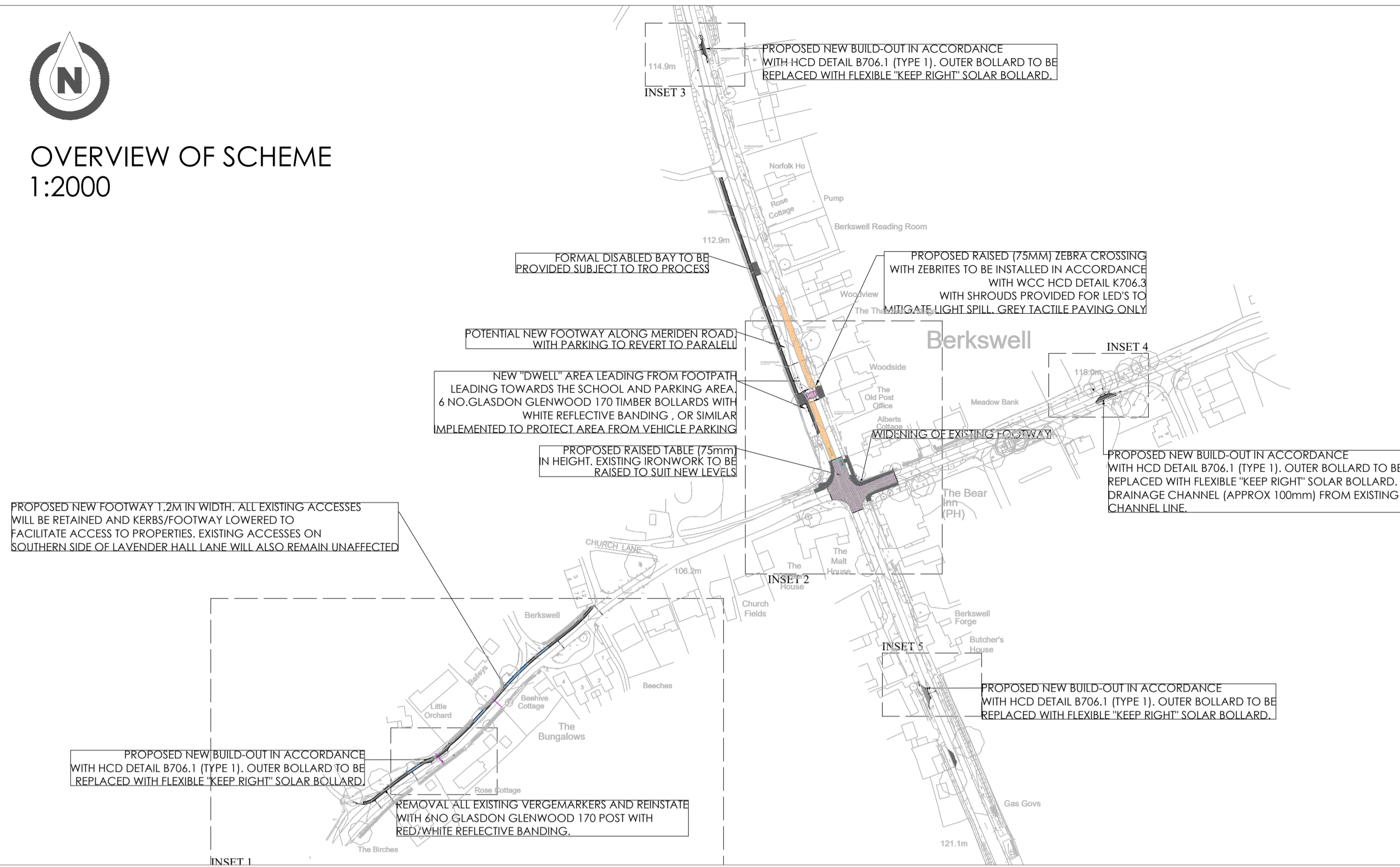

OVERVIEW OF SCHEME
1:2000

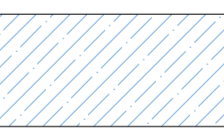

INSET 1 LAVENDER HALL LANE
1:2000



NEW HIGHWAY FOOTWAY

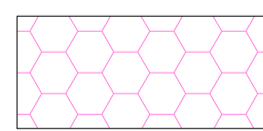

PROPOSED RAISED TABLE / BUILD OUT

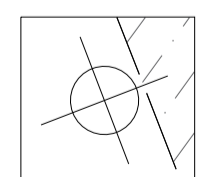

GLASDON GLENWOOD 170 BOLLARDS SPACED AT INTERVALS OF APPROX 2.0M TO THE AREA EAST OF THE CROSSING AND APPROX 6.0M INTERVALS FOR THE APPROACH AT LAVENDER HALL LANE

DO NOT WORK FROM REDUCED DRAWINGS.
PLEASE REFER TO SCALE AND SHEET SIZE AS INDICATED.
Dimensions to be verified on site. This drawing should not be scaled. Any discrepancies should be referred to the Engineer prior to work being put in hand.

- 1) ZEBRA TO BE ON A RAISED CROSSING AT A HEIGHT OF 75MM.
- 2) ZEBRITES TO BE PROVIDED.
- 3) LED LIGHTS TO BE PROVIDED WITH A SHROUD TO MITIGATE LIGHT SPILL.
- 4) ALL TACTILE PAVING TO BE GREY IN COLOUR.



INSET 2 - ZEBRA CROSSING AND RAISED TABLE
1:500



INSET 6 - PRIORITY BUILD-OUT LAVENDER HALL LANE
1:200

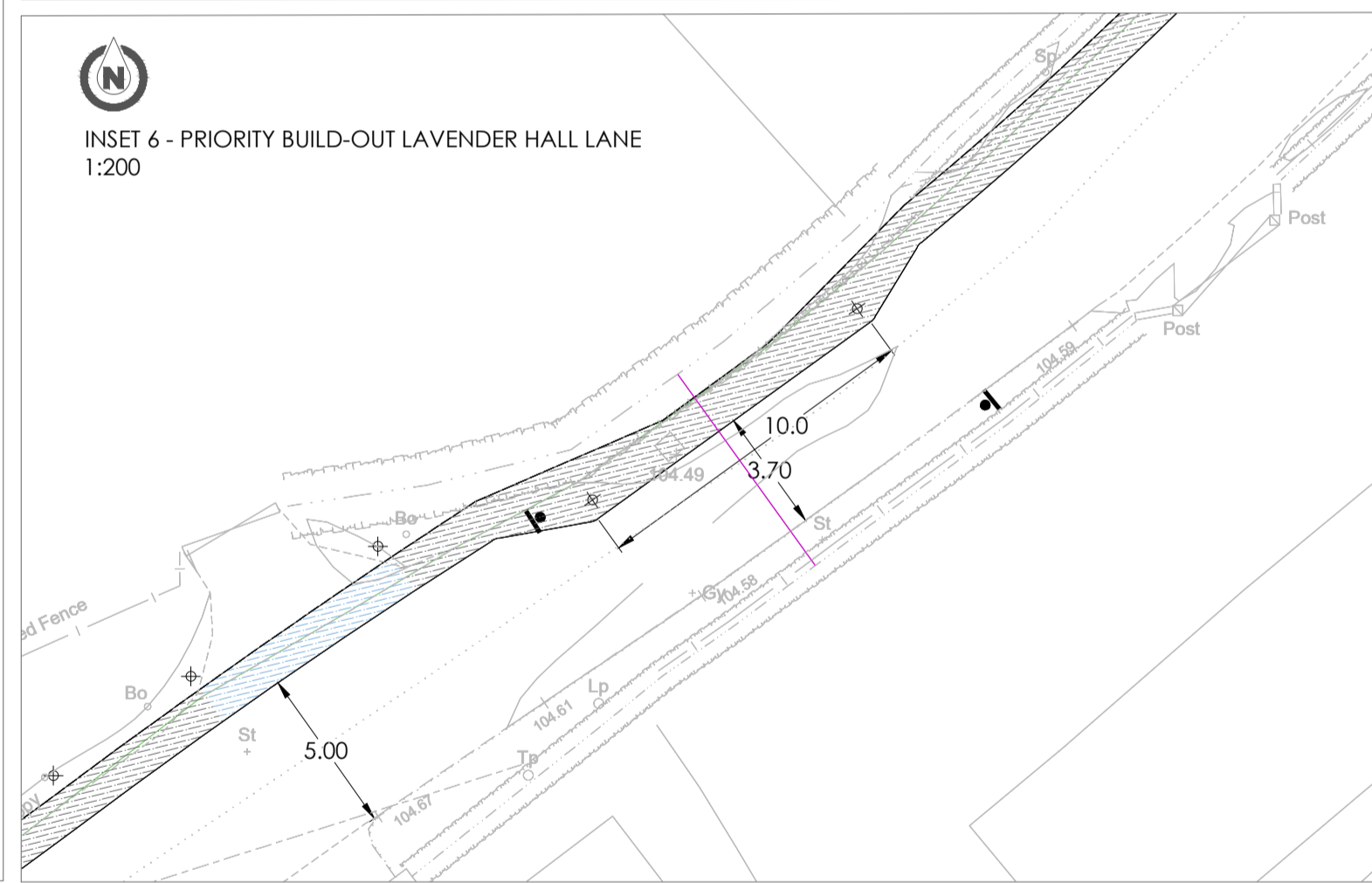

INSET 3 - PRIORITY BUILD-OUT MERIDEN ROAD
1:200

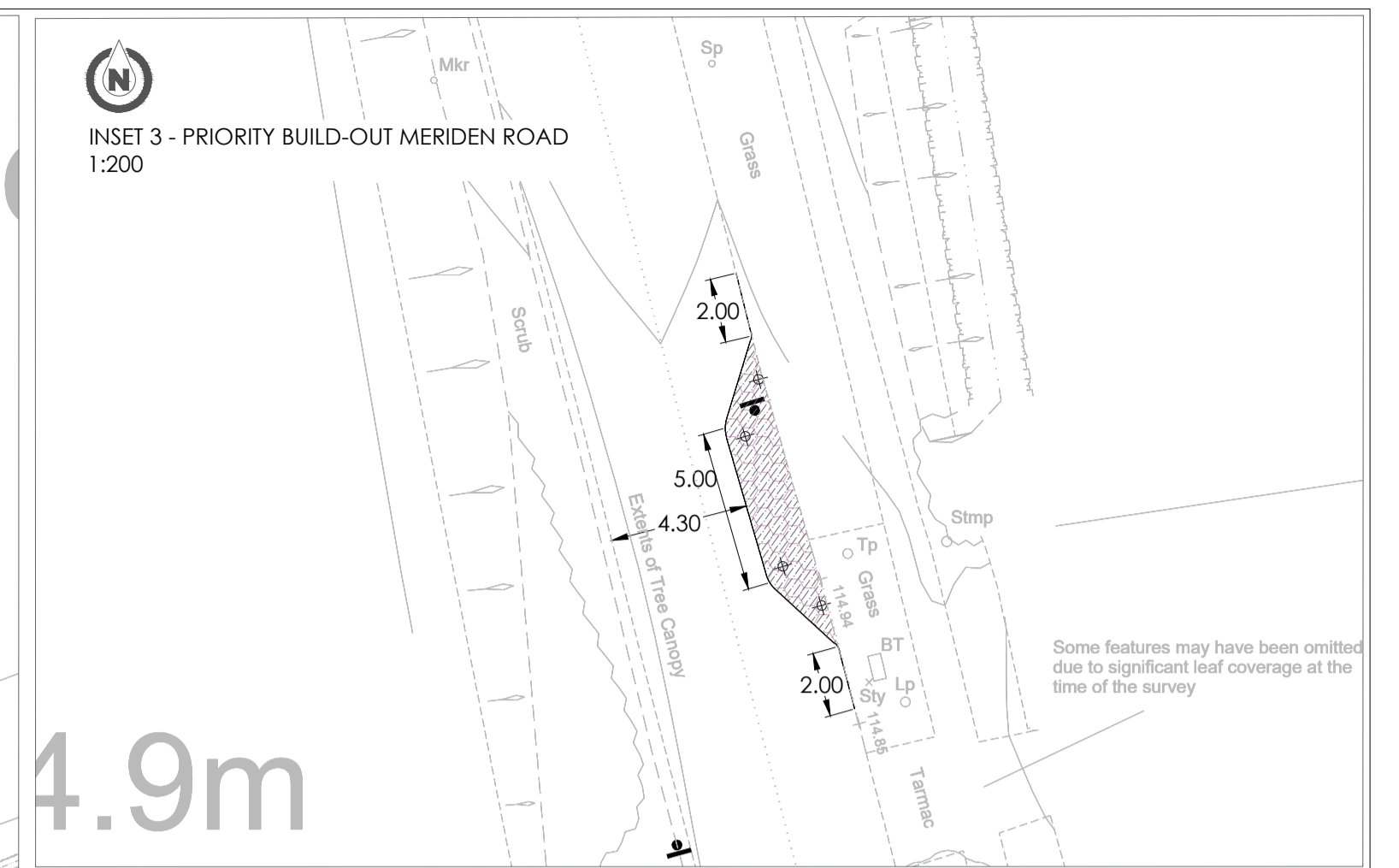

INSET 4 - PRIORITY BUILD-OUT COVENTRY ROAD
1:200

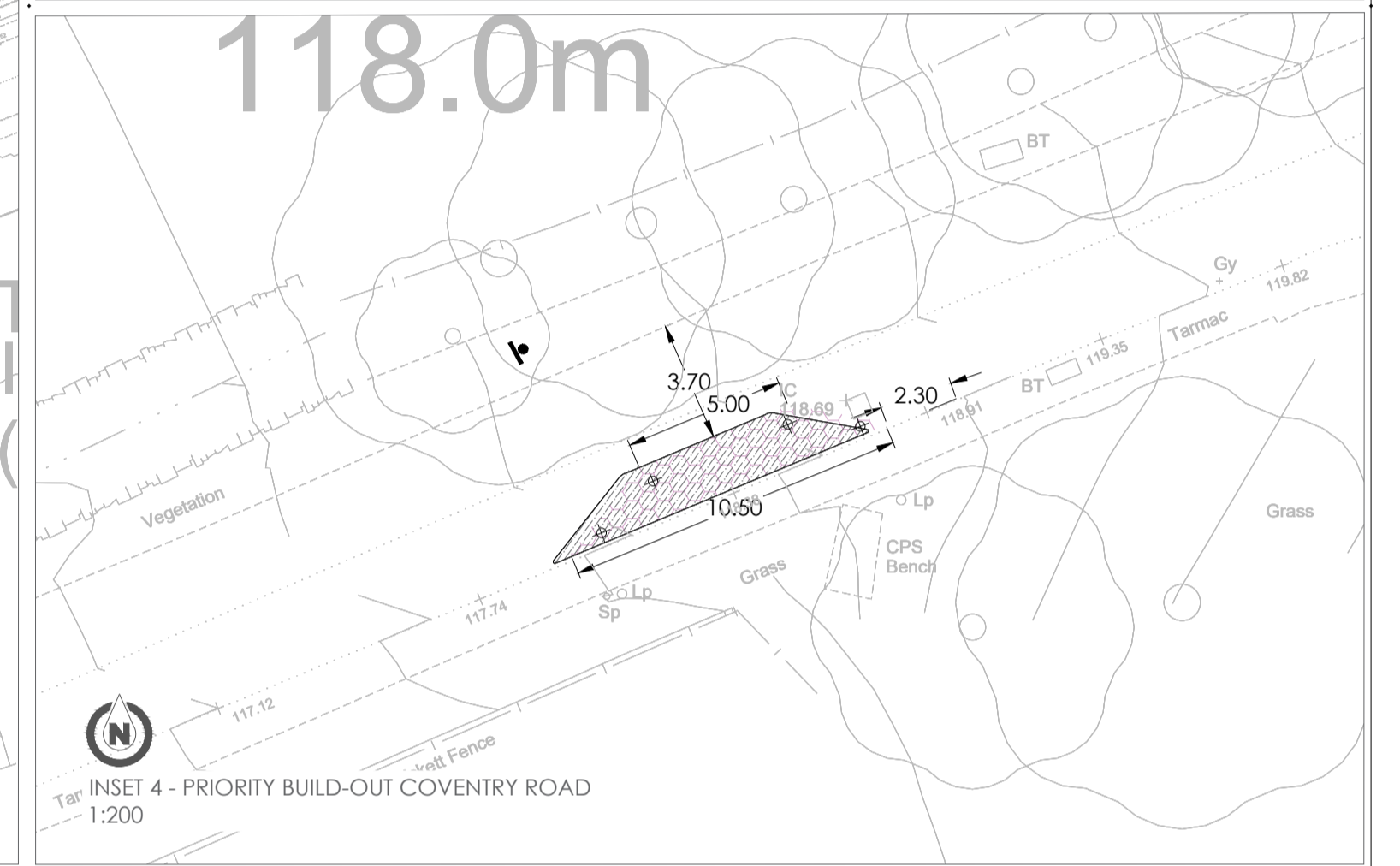

INSET 5 - PRIORITY BUILD-OUT SPENCERS LANE
1:200

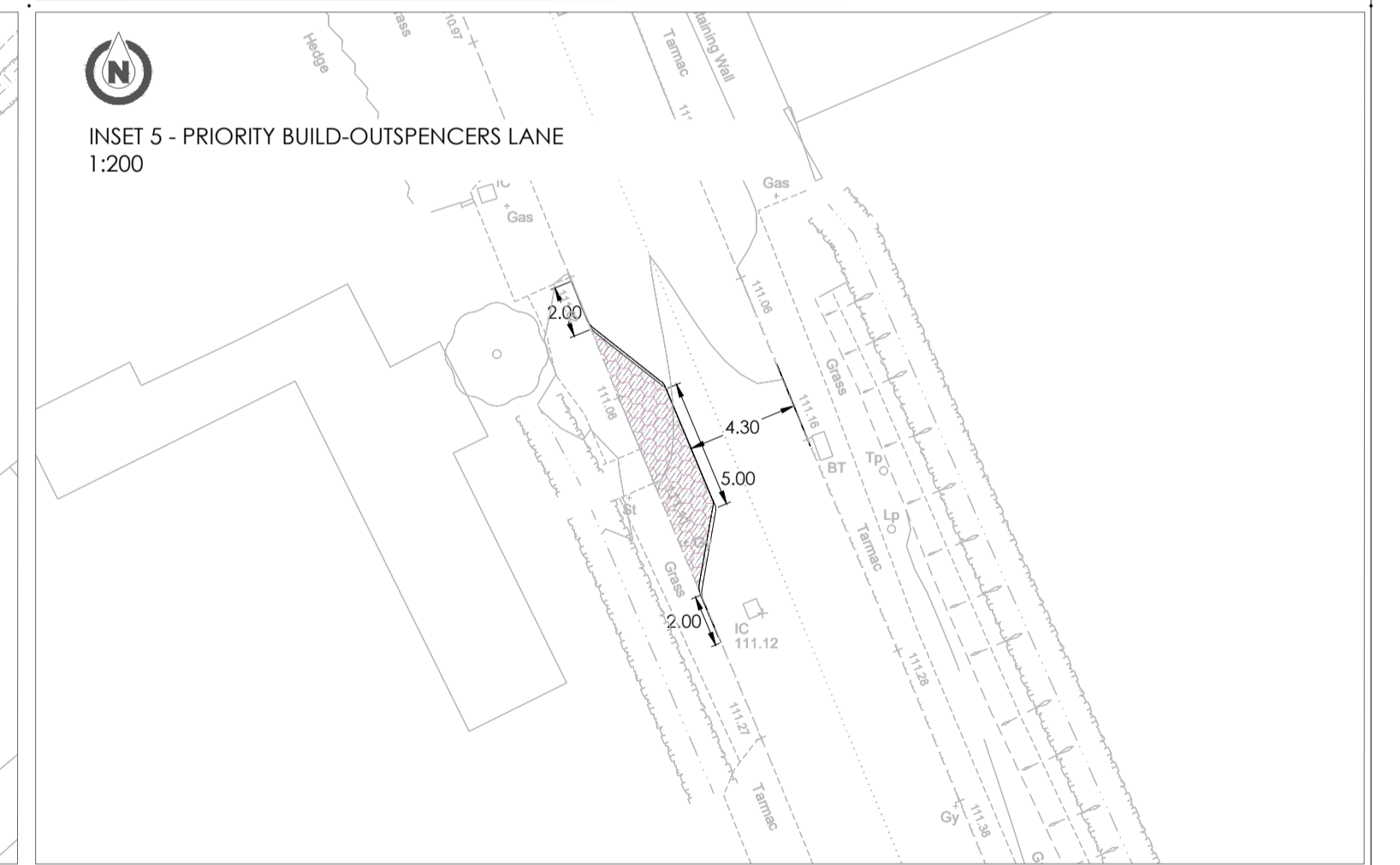

REV	BY	DESCRIPTION	CHKD	DATE
A	SP	AMENDED IN RESPONSE TO ROAD SAFETY AUDIT COMMENTS		29.01.2021

Solihull MBC Licence No. 100023139
Contains Ordnance Survey data © Crown Copyright and database right 2020

Drawing name:
BERKSWELL
BETTER STREETS 20/21
GENERAL ARRANGEMENT

Scale @ A1: AS SHOWN Date: 07/12/2020

Drawn by: SP Checked by: DM

Scheme number: 02-236063 Approved: PM

2020/0100/01.0 Revision: A